

## USER'S MANUAL

# ORION

### HAIR STRAIGHTENER WITH CERAMIC PLATES

“Wet&Dry” function

Auto cut off

**Model: OR-FI02**

**ENGLISH GB**

#### KEY TO MAIN COMPONENTS OF THE APPLIANCE

1. Ceramic plates
2. LCD display
3. On/Off button
4. Control buttons
5. Cord with plug
6. Hanging loop

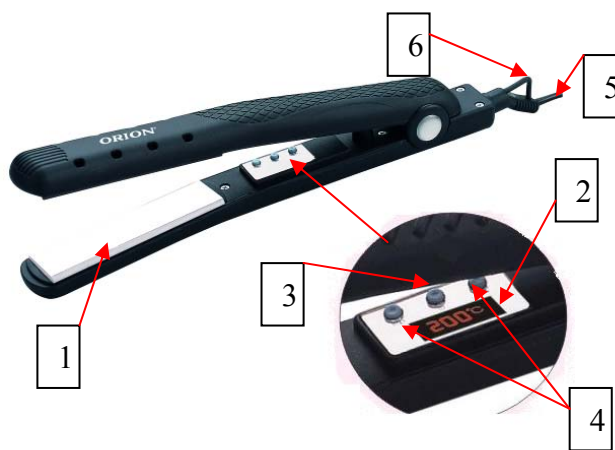

#### SAFETY INSTRUCTIONS

- Read all instructions before using.
- Plug in your appliance using the proper voltage as indicated on your unit.
- Always unplug the appliance immediately after use.
- Do not use while bathing.
- Keep away from water or humid areas (such as sink filled with water).
- Do not place in or drop into water or other liquid.
- If the appliance falls into water, unplug it immediately. Do not reach into the water.
- Do not leave the appliance unattended while it is operating or plugged in.
- Close supervision is necessary when this appliance is used by or near children.
- Use this appliance only for its intended use as described in this manual. Do not use attachments not recommended by the manufacturer.
- Never operate this appliance when it has a damaged cord or plug, if it is not working properly, if it has been dropped or damaged in any manner or dropped into water. Take appliance to the store, where you bought it for examination and repair or mechanical adjustment.
- Keep the cord away from hot or heated surfaces. Do not wrap the cord around the appliance.
- Do not use outdoors.
- Do not place appliance on any surface while it is operating or while switch is turned on.
- Do not use an extension cord with this appliance.

This appliance adopts the most advanced technology and uses **PTC (Positive Temperature Coefficient) as calorific element**. This gives a stable temperature without influence of the outer conditions.

**Solid ceramic plates** provide a better distribution of heat, creating a smoother, flawless finish to the hair and longer lasting results. The plates lock in the hair's natural oils, which retains colour for longer and reduces static build-up.

### **Wet and Dry function**

High heat ceramic plates can straighten hair from wet to dry, steam vents release moisture as hair is straightened.

### **USING THE APPLIANCE**

1. Insert the plug in the mains socket and switch on the power.
2. Press the On/off button to switch on the appliances.
  - The display lights up and shows the temperature
  - The appliance begins to heat up, and you can monitor the actual temperature in the display at any time.
3. Set the desired temperature by pressing the control buttons.
  - The numbers in the display flash, while you set the desired temperature.
  - Available temperature settings are 120°C - 200°C.
4. Use the appliance to set your hair as desired.
5. Switch off the appliance by pressing the on/off button. Remove the plug from the socket as soon as you have finished using the appliance. Always allow it to cool completely before you put it away.
6. The product has **safety cutting off function** after working for 1 hour without any operation during this period.

### **STYLING TIPS**

Brush hair thoroughly before setting. Divide your hair up into small sections, and deal with them separately piece by piece as described below until the desired result is achieved. Hair should be clean and dry before using the appliance.

1. Start with a lock of hair about 5cm wide and close the ceramic plates around the hair near the scalp. Avoid touching the scalp with the hot appliance.
2. Slowly slide the appliance towards the hair ends in one fluent movement. Keep the hair tight to avoid kinks. For more lift in the hair, smooth only the outer part of the hair lock.
3. You can finish by folding the locks inward or outward, if you want the ends to fold.
4. You can finish by twisting the locks around the appliance and holding them for a few seconds to achieve loose curls.
5. For died, bleached, very fine or damaged hair, use a low temperature.

### **TO CLEAN**

Unplug the appliance and allow it to cool down. Use a soft; slightly damp cloth to wipe appliance surfaces. Do not allow water or any other liquid to get into the unit.

### **TO STORE**

Unplug the appliance allow cooling, before storing in its box or in a dry place. Never store it while it is hot or still plugged in. Never wrap the cord tightly around the appliance. Never hang unit by the cord. Store the cord loosely coiled. Do not put any stress on the cord where it enters the unit, as it could cause the cord to fray and break.

### **ENVIRONMENTAL TIP**

An electronic appliance should, when it is no longer capable of functioning be disposed with least possible environmental damage. The appliance should be disposed according to the local regulations in your municipality; in most cases you can discharge the appliance at your local recycling center.

### **THE WARRANTY DOES NOT COVER**

- If the above points have not been observed.
- If the appliance has not been properly maintained, if force has been used against it or if it has been damaged in any other way.
- Errors or faults owing to defects in the distribution system.
- If the appliance has been repaired or modified or changed in any way or by any person not properly authorized.

Owing to our constant development of our products on both functionality and design we reserve the right to change the product without preceding notice.

### **SPECIFICATION**

Model:	ORION OR-FI02
Power supply:	110V/60Hz-230V/50Hz
Power:	60-68W
Net/Gross Weight:	0.47kg/0.55kg