

# ORION<sup>®</sup>

## VACUUM CLEANER

---

**Model: ORION OVC-024**

## USER'S GUIDE

**ENGLISH GB**

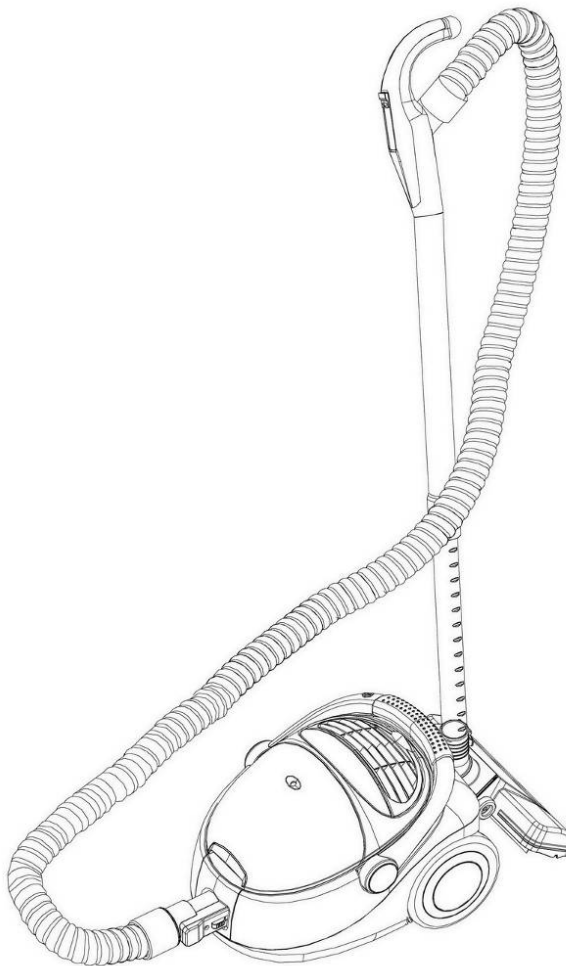

*Please read it carefully before use and save it*

***Dear Customer,***

***Thank you for buying ORION products! Welcome to use!***

***Please read this User's Guide carefully before use and save it.***

***Best regards,***

***ORION ELECTRONICS Team***

***More details: <http://www.orion.ua>***

***Mail to us: [support@orion.ua](mailto:support@orion.ua)***

## **I. Importance & Safety**

● Your vacuum cleaner is an electric appliance: it should be operated under normal conditions. Basic precautions should always be followed to reduce the risk of fire, electrical shock, and injury to person, including the following:

● Material listed as following should not be sucked in, otherwise it may damage the appliance (cause fire, or injure to persons).

1. Hot material, such as ashes, flaming cigarette.
2. Big piece of scraps, such as glass.
3. Poison material (impregnant, corrosive), erosive material (acid material, detergent).
4. Any flammable or volatile liquid as gasoline or alcohol goods.

● When not in used, cut off the power. Remove the plug from the wall socket before any service like clean, check or repair. Never switch off the appliances by pulling the plug.

● Avoid to pull or fold the hose, otherwise may cause deformation or damage.

● Make sure the rated voltage is conform with the supplied power.

● Do not let the power cord go through sharp material to avoid damage.

● Do not immerse the appliance into water, or never put the appliance directly in sun or near any heater or the like to avoid deforming of the plastic components or fire accident.

● Never move the appliances by pulling the power cord.

● Never let children play the appliance to avoid suddenness.

● Do not operate the vacuum cleaner if the appliance be drop down and operates abnormally obviously or the power cord is damaged. You should take the appliance to the authorized maintenance store if happen conditions listed above.

● Never operate the appliance when the inlet has been blocked to avoid heat or deforming of the plastic component or damage of the motor. If the power cord is damaged, it should be replaced by the manufacture or its service agent in order to avoid a hazard.

## II. Structure and Components

Structure figure

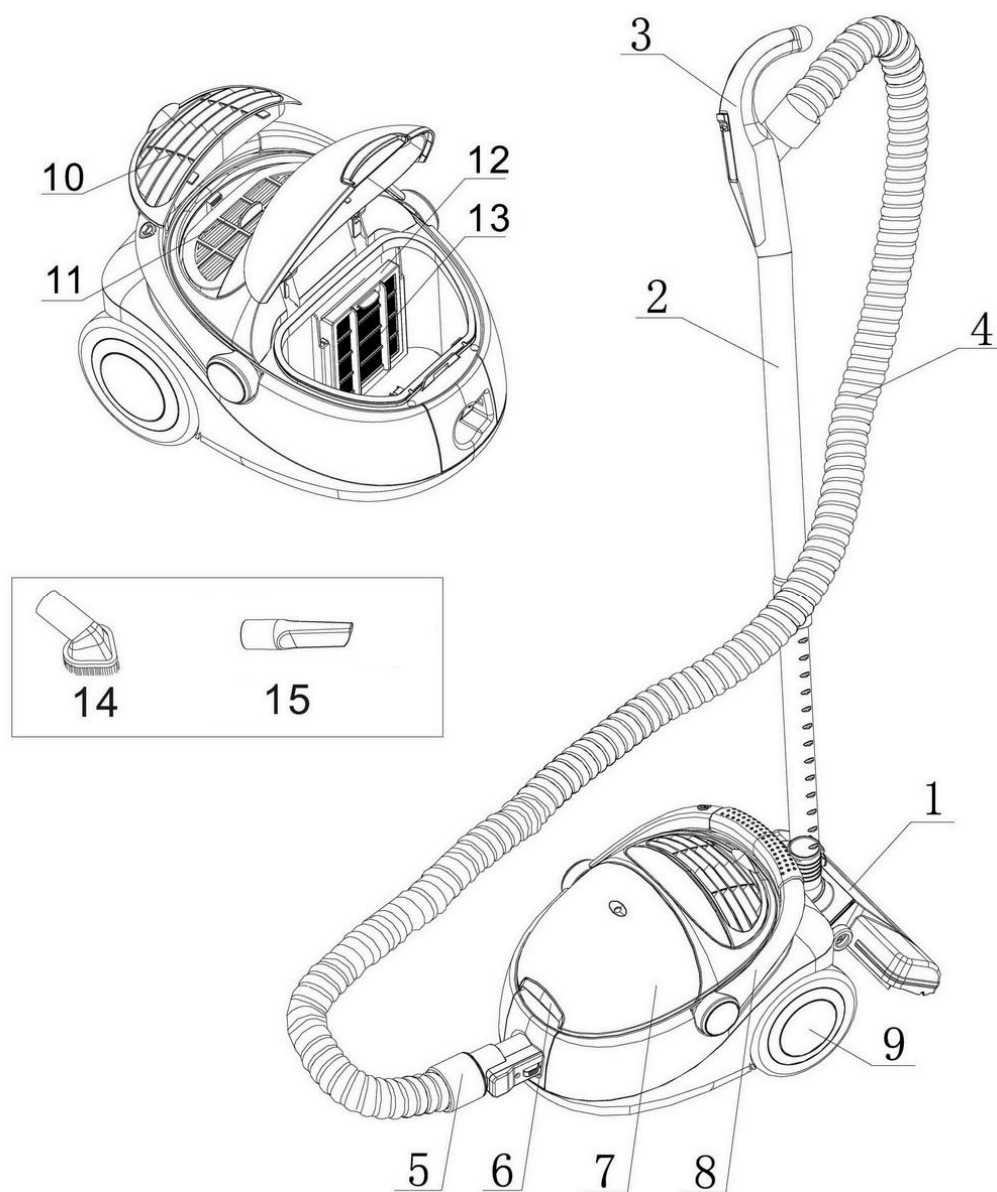

- |                       |                    |                          |
|-----------------------|--------------------|--------------------------|
| 1. Double usage brush | 2. Adjustable tube | 3. Curved tube handle    |
| 4. Hose               | 5. Inhale plug     | 6. Front cover buckle    |
| 7. Front cover        | 8. Handle          | 9. Big wheel             |
| 10. Wind outlet       | 11. HEPA           | 12. Filter rack          |
| 13. Filter piece      | 14. Small brush    | 15. Small Suction nozzle |
| 16. Crevice nozzle    |                    |                          |

## Operation Guidance

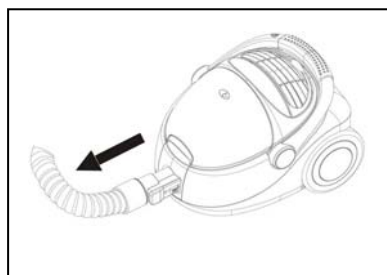

Take out the Inhale plug by pressing the button according to the direction indicated in the figure at left side.

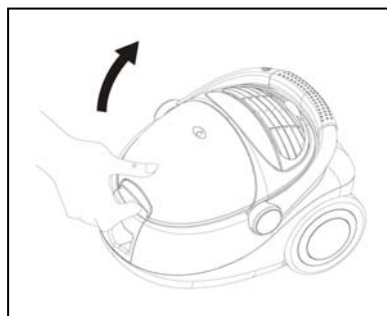

Open the front cover according to the direction indicated in the figure at left side.

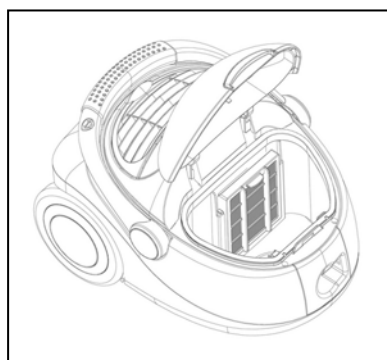

After opening the front cover, check and make sure the filter piece is installed in place.

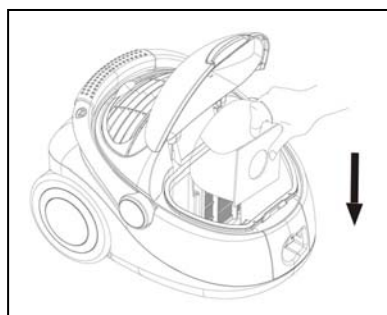

Insert the dust bag into the dust bag rack. Refer to the figure at the left side.

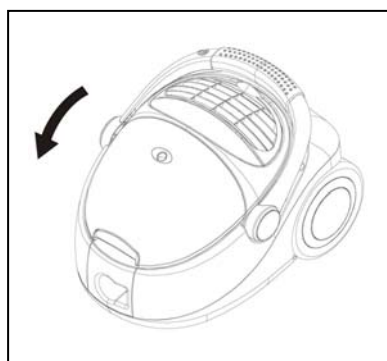

Close the front cover.

●Note: Please check whether installed the dust bag if you can't close the front cover.

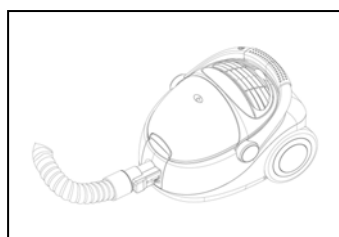

Plug the Inhale plug into the unit.

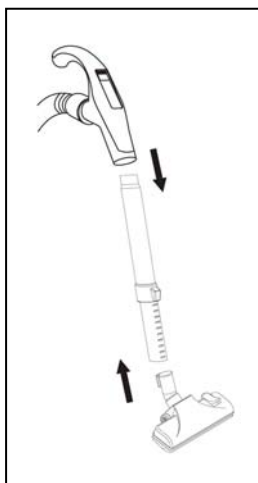

Set in the adjustable tube into the curved tube and floor nozzle. Make sure the connection is firm.

Adjust the tube to a proper length by pushing the control button. And the tube will be lock automatically after releasing the button.

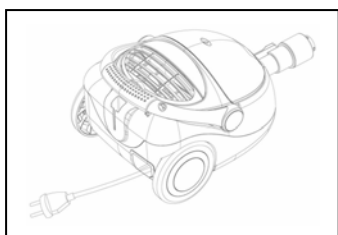
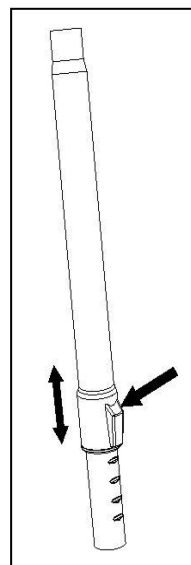

#### Startup and Speed Control

Plug in power cord, press the power switch to startup the machine. Pushing inching switch to control speed.



#### Dust full indicator

Referring to the left figure, the red indicator will move into the middle of the window when the dust bag is full of dust. Now you should switch off the machine, pull out the power plug and rewind the power cord. Then pick out the dust bag for change or clean.

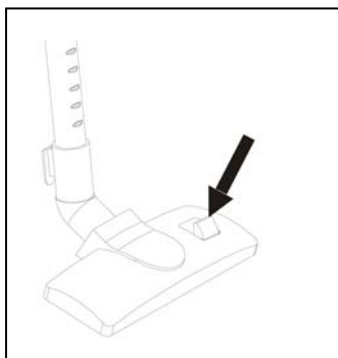

#### Combination floor nozzle

This double-duty brush can be use for cleaning carpet, floor. Adjust the duty of the brush for bare floor cleaning and carpet cleaning by press the relative button. When the floor nozzle extends out brush, it is for bare floor, if without, for carpet.

## Use of accessories

When use the accessories in follow figure, take out the accessory and insert it into the telescopic tube.



Combination nozzle is use for cleaning gap, corner, baseboard and liner gap. The nozzle head can be rotate to the mode of nozzle and brush.



Use the small brush can avoid to injuring surface of furniture and carpet.

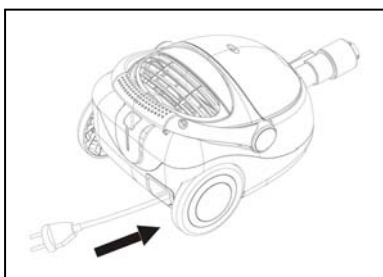

### Stop working of the machine

Press the power switch, pull out the plug from the socket, rewind the power cord by pressing the rewinder switch and hold the plug at the mean time to avoid being injured.

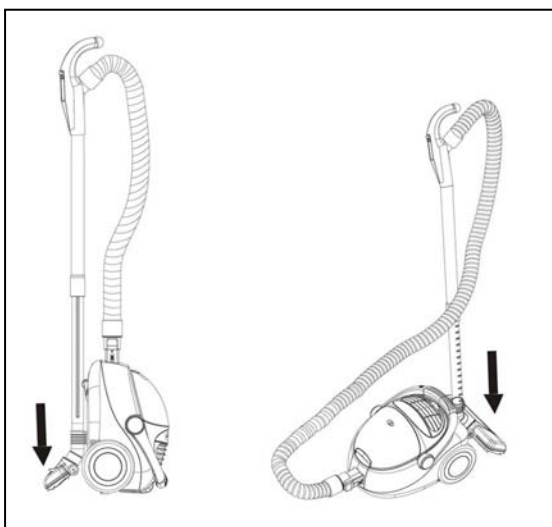

### Disposal

Dispose the hose around the telescopic tube, park the floor nozzle onto the rear side or the bottom of the machine body by a hook on the floor nozzle.

●Note: Avoid to putting the machine under rain or sun.

### III. Dust Empty and Maintenance

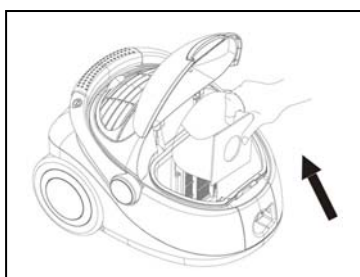

#### A. Empty Dust

Open the front cover, take out the dust bag referring to the left figure. Then put it into the wastebin.

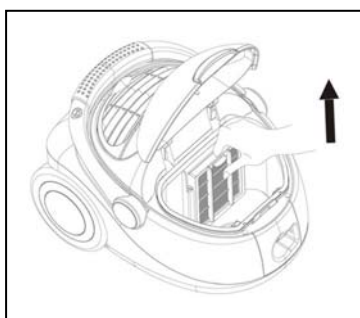

#### B. Maintenance

Take the filter rack apart from the machine according to the direction indicated in the figure at left side. Then take out the filter piece.

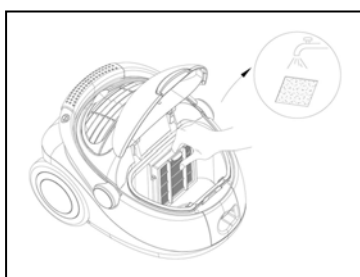

Take out the filter piece, cleaning in water and let it dry naturally.

#### ● Importance

1. The filter piece should be cleaned twice a year. or if it is visibly dustied, clean it at once.
2. When operation, filter piece should be fit in.
3. Make sure it's dry before use. Check if the filter piece is fitted improperly or been damaged before use the machine once.

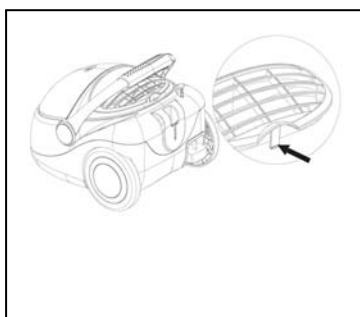

Open the wind outlet: pick up the wind outlet by pressing its buckle according to the direction indicated in the figure at left side.

#### ● Importance

1. The HEPA should be cleaned twice a quarter. Or if it is visibly dustied, clean it at once.
2. When operation, HEPA should be fit in.
3. Check if the filter piece is fitted improperly or been damaged before use the machine once.

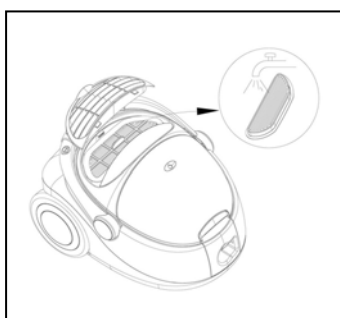

## IV. Trouble Shooting

Note: Cut off power and pull out the plug before starting to get rid of troubles.

If the vacuum power decreasing, and sounds abnormally, stop vacuuming or motor over heat.

Some vacuum components may be blocked.....dredge the blocked component.

Filter been blocked.....clean or replace.

If the trouble still exists, please contact our maintenance service department.

## V. Technical Data Require

Model	ORION OVC-024
Power	Max.1600W
Suction Power	300W
Rated Voltage	230V~
Rated Frequency	50Hz
Noise	74db(A)
Dustbag volume	2,5L
Power cord length	5m
Net weight (without accessories)	4,5kg
Net weight (with accessories)	5,8kg
Gross weight (with accessories)	6,4kg
Body size	365x298x240mm
Box size	495x315x287mm
Approvals	CE, GS, RoHS
Protection Class	Class II Electric Appliance

Extra information on ORION company web-site [www.orion.ua](http://www.orion.ua)

We take your opinion and offers by E-mail [support@orion.ua](mailto:support@orion.ua)