

# ORION®

## VACUUM CLEANER

---

**Model: ORION OVC-026**

## USER'S GUIDE

**ENGLISH GB**

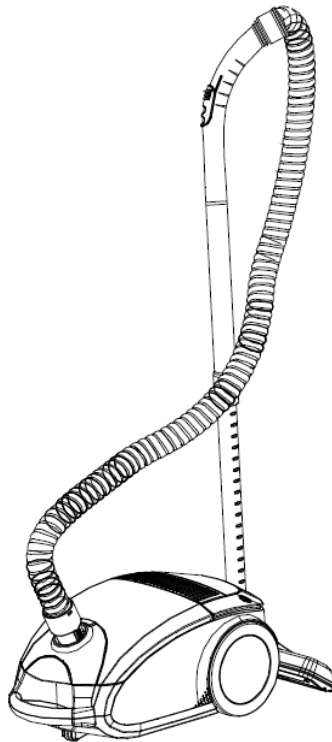

*Please read it carefully before use and save it*

*Dear Customer,*

*Thank you for buying ORION products! Welcome to use!*

*Please read this User's Guide carefully before use and save it.*

*Best regards,*

**ORION ELECTRONICS Team**

*More details:* <http://www.orion.ua>

*Mail to us:* [support@orion.ua](mailto:support@orion.ua)

## **I. Importance & Safety**

- Your vacuum cleaner is an electric appliance: it should be operated under normal conditions. Basic precautions should always be followed to reduce the risk of fire, electrical shock, and injury to person, including the following:
- Material listed as following should not be sucked in, otherwise it may damage the appliance (cause fire, or injury to persons).
  1. Hot material, such as ashes, flaming cigarette.
  2. Big piece of scraps, such as glass.
  3. Poison material (impregnant, corrosive), erosive material (acid material, detergent).
  4. Any flammable or volatile liquid as gasoline or alcohol goods.
- When not in used, cut off the power. Remove the plug from the wall socket before any service like clean, check or repair. Never switch off the appliances by pulling the plug.
- Avoid to pull or fold the hose, otherwise may cause deformation or damage.
- Make sure the rated voltage is conform with the supplied power.
- Do not let the power cord go through sharp material to avoid damage.
- Do not immerse the appliance into water, or never put the appliance directly in sun or near any heater or the like to avoid deforming of the plastic components or fire accident.
- Never move the appliances by pulling the power cord.
- Never let children play the appliance to avoid suddenness.
- Do not operate the vacuum cleaner if the appliance be drop down and operates abnormally obviously or the power cord is damaged. You should take the

appliance to the authorized maintenance store if happen conditions listed above.

- Never operate the appliance when the inlet has been blocked to avoid heat or deforming of the plastic component or damage of the motor. If the power cord is damaged, it should be replaced by the manufacture or its service agent in order to avoid a hazard.

## II. Structure and Components

### A. Structure figure

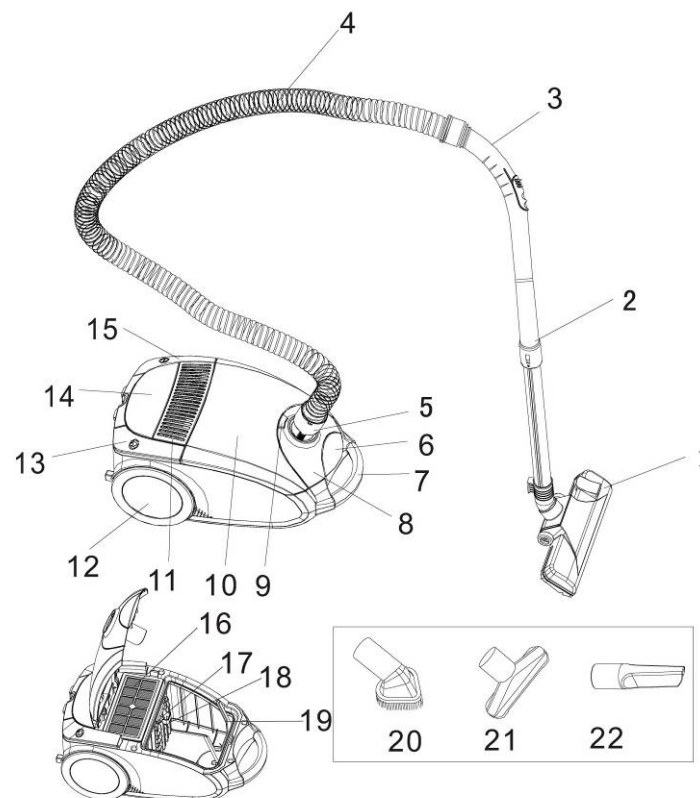

- |                 |                    |                       |
|-----------------|--------------------|-----------------------|
| 1. Floor nozzle | 2. Adjustable Tube | 3. Remote handle      |
| 4. Hose         | 5. Inhale plug     | 6. Front cover buckle |
| 7. Handle       | 8. Front cover     | 9. Inhale button      |

- |                        |                      |                    |
|------------------------|----------------------|--------------------|
| 10. Accessories cover  | 11. Wind outlet      | 12. Big wheel      |
| 13. Cord rewind button | 14. Indicator screen | 15. Power Switch   |
| 16. HEPA               | 17. Filter           | 18. Filter rack    |
| 19. Dust bag rack      | 20. Combined brush   | 21. Suction nozzle |
| 22. Crevice nozzle     |                      |                    |
- B. Operation Guidance

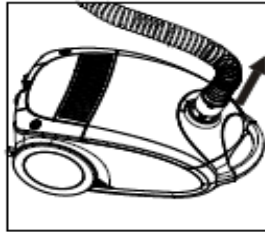

← Take out the Inhale Plug by pressing the button according to the direction indicated in the figure at the left side.

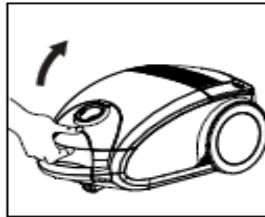

← Open the Rear cover according to the direction indicated in the figure at left side.

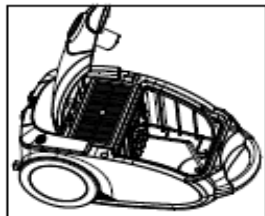

← After opening the front cover, check the HEPA and the filter to make sure they're installed properly.

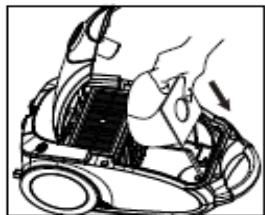

← Insert the dust bag into its rack according to the direction indicated in the figure at left side.

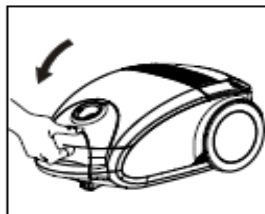

← Close the front cover.

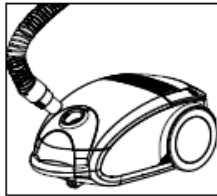

← Plug in the inhale  
Plug into the unit.

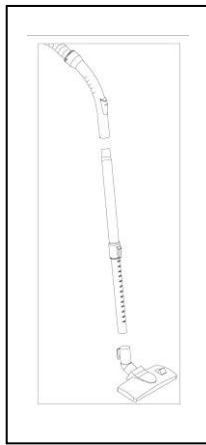

← Set in the adjustable tube into  
the Curved Tube and make  
sure the connection is firm.

Use of the Telescopic chrome  
extension tube.

Adjust the tube to a proper length  
by pressing the control button, the  
tube will be lock automatically  
after releasing the button.

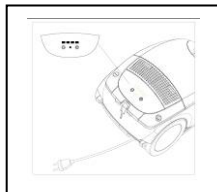
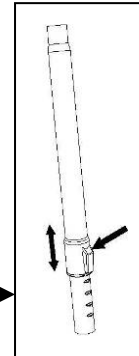

← Plug in power cord, press the power switch to  
startup the machine. 4 steps of speed control  
is available by pressing the speed control  
button on the indicator. Corresponding amount  
of lamps 1 get light, indicating different work  
steps.

Note: When lamp 2 get light, stop machine and  
change dust bag to avoid damaging the  
machine.

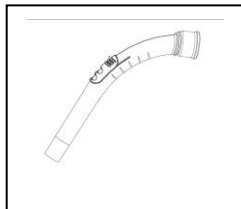

← Adjust the suction power  
Adjust the suction power by pushing the  
adjustment on the curved tube.

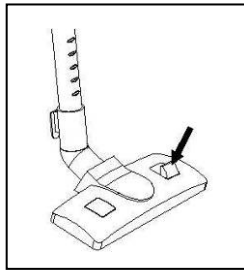

### Combination floor nozzle

This double-duty brush can be use for cleaning carpet and floor. Adjust the duty of the brush for bare floor cleaning and carpet cleaning by press the relative button. When the floor nozzle extends out brush, it is for bare floor, if without, for carpet.

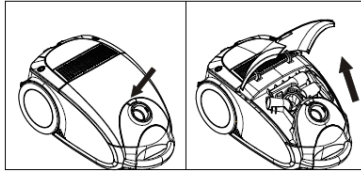

Press the accessory cover and open it. Take out the accessories. When use, insert it into the telescopic tube.



Combination nozzle is use for cleaning gap, corner, baseboard and liner gap. The nozzle head can be rotate to the mode of nozzle and brush.



Use the small brush can avoid to injuring surface of furniture and carpet.



Use for place of dustfull, but the floor nozzle can not reach to.

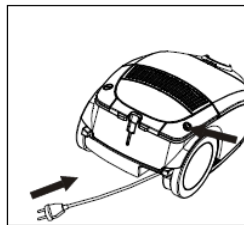

### Stop working of the machine

Press the power switch, pull out the plug from the socket, rewind the power cord by pressing the rewinder switch and hold the plug at the mean time to avoid being injured.

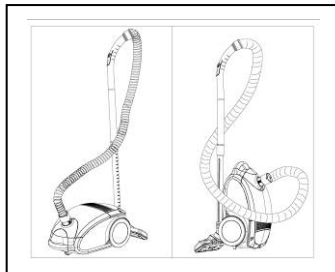

### Disposal

Dispose the hose around the telescopic tube, park the floor nozzle onto the rear or the bottom of machine body by a hook on the floor nozzle.

- Note: Avoid to putting the machine under rain or sun.

## IV. Dust Empty and Maintenance

### A. Empty Dust

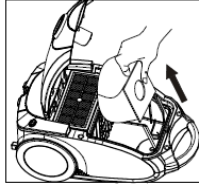

← Take out the dust bag from the machine according to the left figure. Pour out the sewage into a dustbin.

### B. Maintenance

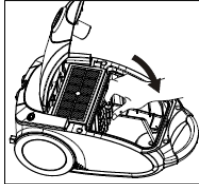

← Take the filtration rack apart from the machine according to the direction indicated in the figure at left side.

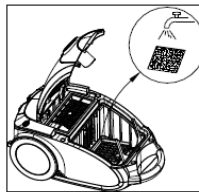

← Take out the filter, cleaning in water and let it dry naturally.

- Importance:

1. The filter should be cleaned twice a year. Or if it is visibly dustied, clean it at once.
2. When operation, dustbag should be fit in.
3. Check if the dust bag is fitted in properly or been damaged before use the machine once.

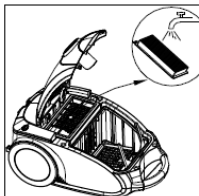

← Open the front cover and take out the HEPA, cleaning in water and let it dry naturally

- Note: HEPA should be cleaned at least once a year.

## V. Trouble Shooting

Note: Cut off power and pull out the plug before starting to get rid of troubles.

If the vacuum power decreasing, and sounds abnormally, stop vacuuming or motor over heat:

Some vacuum components may be blocked.....dredge the blocked component.

Filter been blocked .....clean or replace.

If the trouble still exists, please contact maintenance service department.

## VI. Technical Data Require

|                                  |                             |
|----------------------------------|-----------------------------|
| Model                            | ORION OVC-026               |
| Power                            | Max.2000W                   |
| Suction Power                    | 300W                        |
| Rated Voltage                    | 230V~                       |
| Rated Frequency                  | 50Hz                        |
| Noise                            | ≤78db(A)                    |
| Dustbag volume                   | 4,5L                        |
| Power cord length                | 5m                          |
| Net weight (without accessories) | 5,2kg                       |
| Net weight (with accessories)    | 6,5kg                       |
| Gross weight (with accessories)  | 7,1kg                       |
| Body size                        | 473x280x238mm               |
| Box size                         | 535x335x290mm               |
| Approvals                        | CE, GS, RoHS                |
| Protection Class                 | Class II Electric Appliance |

Extra information on ORION company web-site [www.orion.ua](http://www.orion.ua)

We take your opinion and offers by E-mail [support@orion.ua](mailto:support@orion.ua)