

ORION®

INSTRUCTION MANUAL

TRAVEL IRON
Model: ORI-024

ENGLISH **GB**



Dear Customers, Thank you for buying ORION products!

Welcome to use!

Read the instructions for use carefully before using the appliance and save them for future reference.

IMPORTANT SAFEGUARDS

1. Before connecting the appliance check that the voltage indicated on the type plate corresponds to the mains voltage in your country.
2. This appliance is not intended for use by persons (including children) with reduced physical, sensory or mental capabilities, unless they have been given supervision or instruction concerning use of the appliance by a person responsible for their safety.
3. Do not immerse the appliance in water and other liquids.
4. Do not reach for an appliance that has fallen into water. Unplug it from the wall socket.
5. Do not leave the appliance unattended when it is switched on.
6. Never operate this appliance if it has a damaged cord or plug, if it is not working properly, if it has been dropped or damaged, or dropped into water.
7. To avoid a circuit overload, do not operate another high-wattage appliance on the same circuit.
8. Do not pull the cord to move the appliance. Do not bend or wrap cord around the appliance.
9. Do not use it with wet hands.
10. Switch the appliance off holding plug not cord.
11. Keep the cord away from the hot soleplate.
12. Do not allow children to play with the appliance.
13. The appliance is not intended for commercial use.
14. This appliance should only be used according to its approved purpose. Any other use of it is wrong and therefore dangerous. The manufacturer is not responsible for damages resulting from improper or incorrect use of the appliance. Under these conditions, the guarantee will be cancelled.
15. Regular cleaning and proper maintenance ensure optimal results and a long life for your appliance.
16. The plug must be removed from the socket-outlet before the water reservoir is filled with water.
17. The filling aperture must not be opened during use.
18. When placing the iron on its stand, ensure that the surface on which the stand is placed is stable.
19. To prevent the risk of electric shock, do not disassemble or repair the iron.
20. After using, turn the temperature control knob off or to "MIN".
21. Let iron cool completely before cleaning or putting away.
22. Save this instruction manual for future reference.

DETAILS

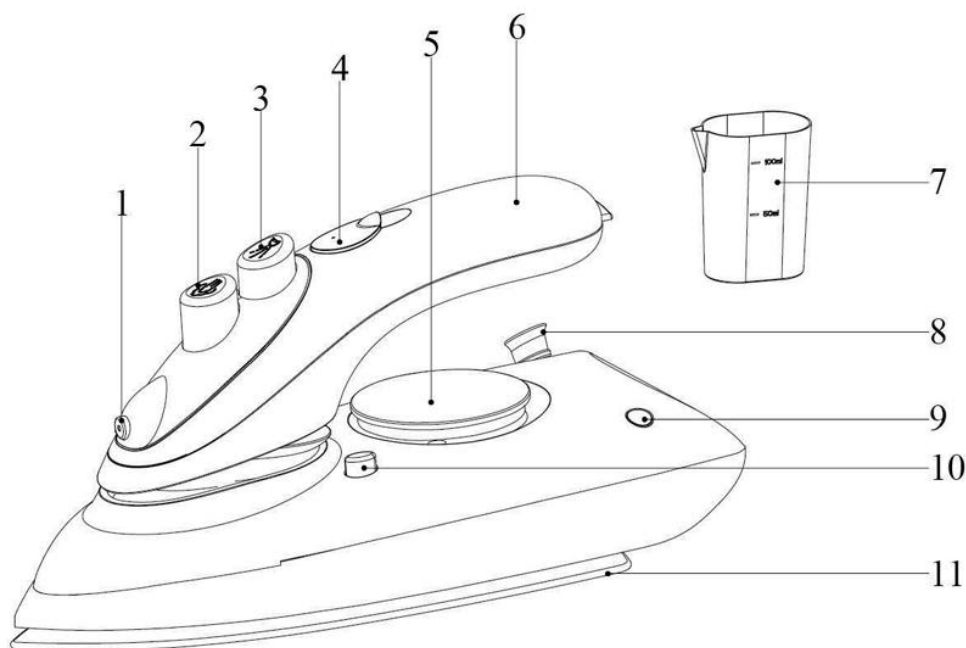

1. Spray nozzle
2. Burst steam button
3. Spray button
4. Water inlet cover
5. Temperature control knob
6. Water tank

7. Beaker
8. Cord sleeve
9. Pilot light cover
10. Handle lock button
11. Soleplate

HOW TO USE

Note:

- Remove any labels, stickers or protective foil that may be attached to the body or soleplate of the iron before first use.
- The iron may give off some smoke and emit an odor when you first use. This will cease after a short while. It is safe and will not harm the performance of the iron.

Filling with water

1. Remove the mains plug from the wall socket before filling the iron.
2. Open water inlet cover.
3. Use the water beaker attached to fill clean tap water into water tank until "MAX" filling level.
4. Replace water inlet cover.

Note:

- If the water is very hard it is advisable to use distilled water mixed with tap water.
- Do not fill the tank beyond the MAX indication.
- Do not put perfume, vinegar, starch, descaling agents, ironing additives chemically descaled water or other chemicals in the water tank.

Setting the temperature

Fabric	Temperature control
NYLON/ACRYLIC/ACETATE	●
SILK/RAYON/POLYESTER	● ●
WOOL/COTTON	● ● ●
LINEN	MAX

1. Stand the iron on its heel and plug the power cord into wall socket.
2. Turn the iron temperature control knob until you get the desired fabric/temperature setting. We recommend using the above table as a guide.
3. The temperature pilot light will light, indicating that the soleplate is heating up.
4. When the pilot light goes out, the required temperature has been reached. The temperature pilot light will go on from time to time during ironing.

Dry ironing

1. Turn the temperature control knob to select the desired fabric/temperature setting. The indicator pilot light will light, put the iron on the smooth and stable place vertically.
2. When the indicator pilot light goes out, the required temperature has been reached.
3. You can begin to iron.

Spraying

1. Ensure there is enough water in the water tank.
2. Press the spray button to produce a fine spray of spray nozzle and continue ironing

Note: Do not spray silk.

Strong steam

This function is used to iron out deep wrinkles, to iron cuffs and coarse fabrics.

1. Ensure that there is enough water in the water tank.
2. When the temperature control knob is set to steam setting (between “●●” to “MAX”) strong steam can be used.
3. Press the burst steam button, the soleplate will spray out strong steam.

Note:

- Only use the steam push button when the steam iron has reached the steam or maximum temperature.
- Do not press this burst steam button more than 3 times at once. For optimal steam output, leave an interval of at least four seconds between pressing the burst steam button.
- Never direct the steam towards people and animals. Burns or serious injury may occur.

Vertical shot of steam

1. Hang your clothes on a hanger
2. When the temperature control knob is set to a steam setting (between “●●” to “MAX”) vertical steam can be used.
3. Ensure that there is enough water in the water tank.
4. Simply hold the iron vertically, positioned in front with a slight distance from the item to be steamed, and press the burst steam button.

Note:

- Never direct the steam towards people and animals. Burns or serious injury may occur.

Foldable handle lock

- Before ironing, at first raise the handle until it locks into position.
- For storing press the lock down to close the handle.

CARE AND CLEAN

1. Unplug the iron from wall socket, and allow the appliance completely cool down.
2. Clean it with a damp cloth and then with dry cloth.
3. Do not immerse the unit into water or other liquids.
4. Regularly rinse the water tank with water, empty the water tank after clean.
5. Never use scouring pads, abrasive or chemical cleaners, or solvents to clean the exterior or soleplate of your iron.
6. After use, set the temperature control knob to MIN position, disconnect the unit from main socket, empty remaining water from water tank and then store the iron after it has been completely cooled down.

CHARACTERISTICS

- Travel iron
- Adjustable temperature for different fabrics
- Dry/Spray/Burst steam iron
- Water spray: 0.4 g/time
- Burst steam: 25 g/min
- Ceramic coating soleplate
- Transparent water tank: 45ml
- Foldable handle
- Temperature pilot light
- Power supply: 230V ~50Hz
- Power: 1000W
- Cable: 1,8m
- Protection against electric shock: I
- Water protection: IPX0
- Net/Gross weight: 670/860g
- Gift Box Size: 233X100X110mm
- Color: white, purple

Subject to change without notice

Extra information on ORION company web-site www.orion.ua

We take your opinion and offers by E-mail support@orion.ua